

SMALL



THIN

15mm



The small & thin design or a small robot which does not take up space and can be placed anywhere!

WIREFLESS POWER SUPPLY
 720mW+Transmits 4 signals

Transmits (Receive)
 RS04T-F1-PU01

Electric Power equals to 24 LEDs

Output (Transmission)
 RS04E-F1N-PU02
 RS04E-F1P-PU02

*It is LED conversion of consumption electricity 30mW

System configuration

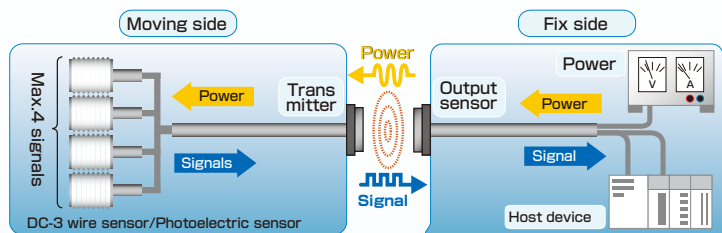

Wireless feeds the transmission part which is connected to the movable side by supplying a power supply to the output part which install in the fixed side, and this system can let you drive four points of connected sensors.

The fixed side can feed back ON/OFF signal with a sensor at the same time. And it can completely make a sensor wireless.

Product news

Easy installation on to the small robot!

Small size, 35x35x15mm, attached to a robot hand putting on and off. And can perform the feeding to a grasp confirmation sensor and the ON/OFF signal transmission from a sensor smoothly. It can be protected from water and oil, mine dust environment with protection of IP67.

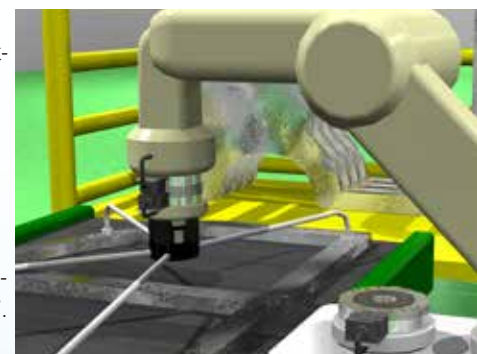

Size
35 x 35

Operating distance
0...2mm

Transmitter

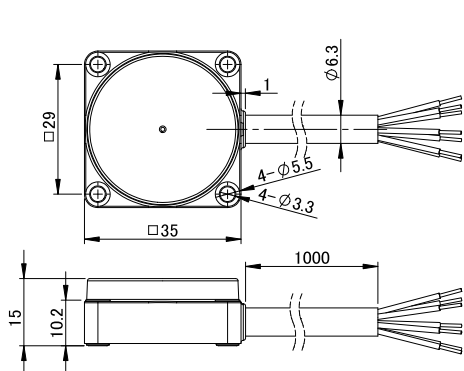

Output sensor

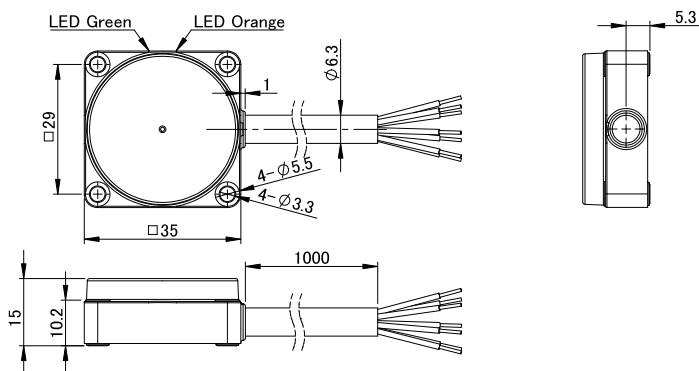

Transmitter	
Type code	RS04T-F1-PU-__
Applicable sensor	DC 3-wire sensor
Drive voltage	12V ± 1.5V DC
No. of Input signals	4 signals
Drive current	≤ 30mA ≤ 60mA
Operating distance	0...3mm 0...2mm
Center offset	± 2mm ± 1mm
Operating temperature	0...+50°C
Protection class	IP67
Cable	PUR φ 6.3 / 7x0.259mm ²
Material	ABS
Weight	Body 25g + Cable 60g/m

output sensor	
Type	NPN RS04E-F1N-PU-__
code	PNP RS04E-F1P-PU-__
Supply voltage	24V DC ± 10% (including ripple)
Current consumption	≤ 200mA
No. of output signal	4 signals + 1 signal (Inzone)
Load current	max.50mA per output
LED indication	Status (green), in zone (bitter orange)
Circuit protection	Short circuit protection, Converse protection, Surge suppression
Operating temperature	0...+50°C
Protection class	IP67
Cable	PUR φ 6.3 / 7x0.259mm ²
Material	ABS
Weight	25 g +Cable 60g/m

Please be routed through the resistance when you are using the DC-2 wire sensor.
Please refer to the User's Guide.

Applicable sensor

Supply voltage	12V DC
Total current consumption	≤ 60mA
Residual voltage	≤ 3.5V
Load current	---

Total current consumption of detectors must not exceed the rated drive current.Reduce the switches when the total current consumption exceeds the drive current.
When exceeding a drive electric current level, please reduce the number of sensors to connect.

Installation notes

In order to avoid influence of surrounding metal, or to avoid mutual influence between parallel-mounted sensors, keep the minimum free zone as described below. (Clamping torque of the screw ⇒ 0.63N·m)

Typical Transmitting Diagram (Supply voltage at 24V / non-flush mount)

RS04T-F1-PU-__ / RS04E-F1N-PU-__、RS04E-F1P-PU-__

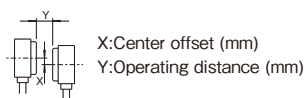
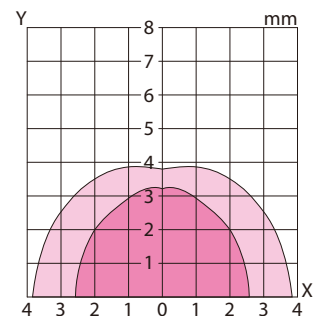

Movement range	Center offset	Drive current
0...3mm	± 2mm	≤ 30mA
0...2mm	± 1mm	≤ 60mA

Surround Metal

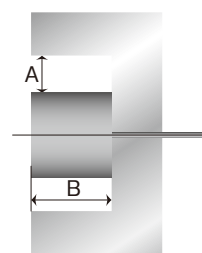

Parallel Setting

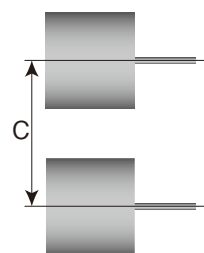

Type code	A	B	C
RS04T-F1-PU-__	20	15	110
RS04E-F1N-PU-__、RS04E-F1P-PU-__			

(mm)

* Possible that only one side, the metal contacts.

■ Infor may change the mention contents such as specifications without a notice.
Thank you for understanding

Wireless Power Supply by
B & PLUS K.K.

Mail : b-plus-usa@b-plus-kk.com

Web : http://www.b-plus-kk.com

* Contents is subject to change without notice.