

| | | | | |
|--------------------------------|-----------|-----------|-----------|-----------|
| Housing size | M30 x 1.5 | M30 x 1.5 | M30 x 1.5 | M30 x 1.5 |
| Mounting type | Shield A | Shield A | Shield A | Shield B2 |
| Rated operating distance(Sn) | 10mm | 10mm | 10mm | 12mm |
| Assured operating distance(Sa) | 0...8mm | 0...8mm | 0...8mm | 0...9.6mm |

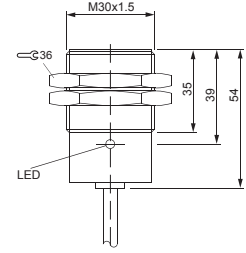

| | | | | | |
|-------------------------------|-------------------|--------------------------------|--------------------------------|--|--------------------------------|
| Type number | DC2W N.O. N.C. | BR3-3010D BR3-3010D1 | BR5-3010D BR5-3010D1 | BC5-3010D - | BR5-3012F - |
| Rated operational voltage(Ue) | | 12...24V DC | 12...24V DC | 12...24V DC | 12...24V DC |
| Supply voltage(Us) | | 10...30V DC | 10...30V DC | 10...30V DC | 10...30V DC |
| Voltage drop(Ud) | | =<3.5V | =<3.5V | =<3.5V | =<3.5V |
| Rated operational current(Ia) | | 4...100mA | 4...100mA | 4...100mA | 4...100mA |
| Off-state current(Ir) | | =<0.65mA | =<0.65mA | =<0.5mA | =<0.65mA |
| Circuit protection | | Polarity, Short circuit | Polarity, Short circuit | Polarity, Short circuit | Polarity, Short circuit |
| - | | - | - | - | - |
| Ambient temperature range(Ta) | | -25...+70degrees C | -25...+70degrees C | -25...+70degrees C | -25...+70degrees C |
| Frequency of operation(f) | | 300Hz | 300Hz | 300Hz | 200Hz |
| LED indication | | Function | Function | Function | Function, Setting |
| Protection class per IEC60529 | | IP67 | IP67 | IP67 | IP67 |
| Material | Housing | Nickel plated brass | Nickel plated brass | Nickel plated brass | Nickel plated brass |
| | Active surface | Poly Propylene | Poly Propylene | Poly Propylene | Nylon |
| Connection | | Cable | Cable | connector/M12 | Cable |
| Cable | Outer sheath | PVC | PVC | - | PVC |
| | Diameter/core | Φ 5mm / 2 x 0.5mm ² | Φ 5mm / 2 x 0.5mm ² | - | Φ 5mm / 2 x 0.5mm ² |
| | Length | 2m,3m,5m | 2m,3m,5m | - | 2m,3m,5m |
| Remarks | | | | Pin assignment of NO &NC 1 = +, 3 = - | |

*In ordering, please specify cable specification (outer sheath and length) as following example.

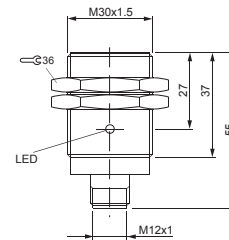
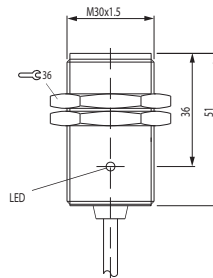
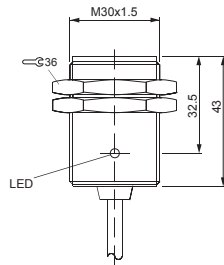
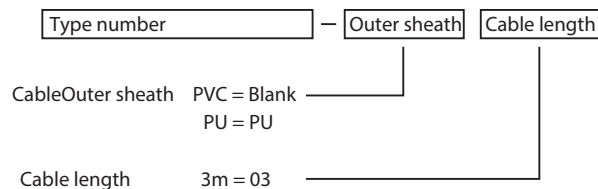

Ordering example (PVC cable 3m)

BR3-3010D-03